

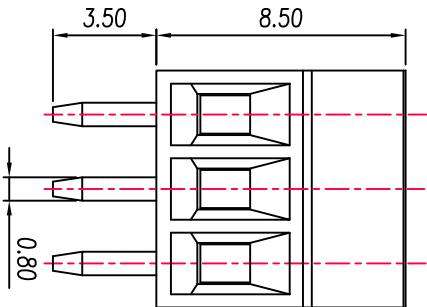

宁波新三和连接电气有限公司

NINGBO NEW SANHE ELECTRIC CONTACT CO., LTD.

产品规格书
THE SPEC SHEET

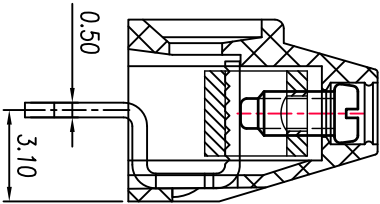

Standard UL

Rated voltage	150V
Rated current	6A
Contact resistance	20mΩ
Insulation resistance	500MΩ/DC500V
W/rt standing voltage	AC 2000V/1 Min
Wire range	22~18AWG

Standard IEC

Rated voltage	160V
Rated current	6A
Wire range	1.0mm ²

Temp.Range -40°C~+105°C

MAX Soldering +250°C for 5 Sec

Torque 0.15Nm

Steip Length 4-5mm

Pitch 2.54mm

Poles 2-12p

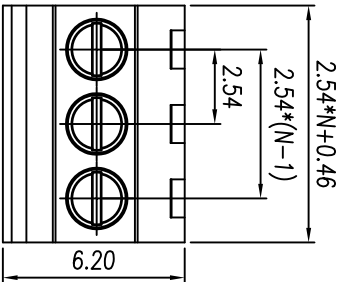
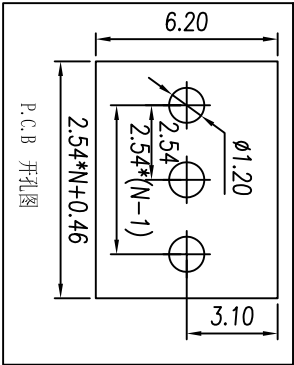

linear dimension

	over 18 to 30	over 30 to 50	over 50 to 80	over 80 to 120	over 120 to 160	over 160 to 200	all to 5	over 5 to 30	over 30 to 120	over 120 to		
variable range	10	30	50	80	120	160	200	5	30	120		
tolerance	±0.15 to	±0.25 to	±0.35 to	±0.45 to	±0.60 to	±0.75 to	±0.90 to	0.5 to	0.025 to	0.06 to	0.12 to	0.4

D

D

B

B

C

C

A



宁波新三和连接电气有限公司
NINGBO NEW SANHE ELECTRIC CONTACT CO., LTD.

中国宁波象峰
TEL: +8657463226970
FAX: +8657463226980

D

1